



Reach out to Northshore address

HAMILTON Reach is offering a new level of apartment living in the Northshore urban renewal precinct.

Designed as a residential enclave that embraces the three assets of its location - river, park and golf course - Australand believe the development is one of the most significant residential projects of the year.

Watermarque Residences is the \$55 million first stage and features a collection of 78 contemporary apartments across two five-storey buildings, priced from \$360,000 to \$1.5 million.

Designed by architectural firm Arqus Design, Watermarque's apartments provide spacious, contemporary dwellings that maximise the site's attributes, with the majority of apartments offering sweeping river views or tranquil parkland outlooks.

Apartments in the first stage will range in size from 56sq m to 333sq m and will offer functional and well appointed living spaces with panoramic views while maintaining privacy.

Featured is the Watermarque North 08 design, a 90sq m two-bedroom apartment with open-plan dining and living and a large balcony.

Both bedrooms have built-in wardrobes and

the main bedroom has an ensuite with large shower, while the main bathroom features a combined bath and shower.

The kitchen is modern with quality fixtures and finishings, modern cabinetry and a breakfast bar. The balcony is 12sq m and overlooks the parklands.

Bordered by 530 metres of absolute river frontage, 2.5 hectares of tranquil parkland, and the Royal Queensland Golf Club, Hamilton Reach is within proximity to the CBD, transport links, and entertainment and dining precincts at Portside Wharf and Racecourse Road.

The site is on MacArthur Ave and was unaffected by the January 2011 floods, with the ground floor apartments to be built two metres above the recent flood peak.

Hamilton Reach will be the first development along the eastern side of the Urban Land Development Authority's Northshore precinct, which is being transformed from an industrial area into a vibrant riverside mixed-use community.

Construction on a \$5 million CityCat terminal commenced in early 2011 and is expected to be completed by the middle of the year.

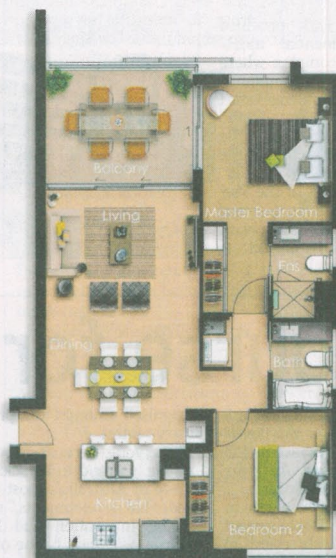

HAMILTON REACH

FACTS

DESIGN

Watermarque North 08

DEVELOPER

Australand

PRICE

\$562,000

LOCATION

Northshore, Brisbane

ADDRESS

310 MacArthur Ave

OPEN

Tuesday to Sunday 10am-5pm

PHONE

133 838

WEBSITE

www.australand.com.au/hamiltonreach

FIGURES

SIZE	DEPTH	WIDTH
90sq m	12.2m	7.4m
BEDROOMS	BATHROOMS	PARKING
Two	Two	One

FEATURES-AMENITIES

- Living, balcony and main bedroom overlook tranquil parkland
- Quality fixtures and finishes
- Sustainability initiatives implemented
- Exclusive recreation facilities
- Building materials embrace natural environment
- 530m of absolute riverfront living
- 2.5ha of tranquil parkland
- 450m of golf course frontage
- Northshore Café on its doorstep
- 1km to Gateway, 5km to airport, 6km from CBD
- Unaffected by the 2011 flood

